



**BREATHE EASY...Solutions for Clean, Safe Air**

# HYDROMAX® WC5000 / WCDDT7230 Specifications and Technical Data

## TYPICAL APPLICATIONS:

- SAFE COLLECTION OF ALUMINUM, TITANIUM AND OTHER COMBUSTIBLE DUSTS
- GRINDING DUST AND PARTICULATE
- EXPLOSIVE DUST COMPOUNDS
- SPARKING / COMBUSTIBLE MATERIALS
- POWDERS & OTHER DRY DUSTS



## STANDARD FEATURES:

- MIST ELIMINATOR FILTERS
- INTERNAL BAFFLE SECTION
- SUMP WITH SLOPED FRONT FOR EASY CLEAN-OUT
- ALL STAINLESS STEEL CONSTRUCTION WITH MARINE GRADE BLACK EPOXY FINISH
- NEMA 4 CONTROL PANEL WITH VISUAL HEADS-UP DISPLAY AND INTEGRAL MOTOR CONTROLS INCLUDING PANEL MOUNTED START/STOP PUSHBUTTONS

## STANDARD FEATURES:

- EQUIPMENT INTERLOCK - :HYDROMAX® IS STANDARD WITH A LOW LEVEL SHUT-OFF RELAY AND MOTOR RUN RELAY TO INTERLOCK WITH DUST PRODUCING EQUIPMENT
- SUMP OVERFLOW VISUAL ALARM THAT SHUTS UNIT DOWN

## OPTIONS:

- POWERED SUMP VENT BLOWER
- WCDDT7230 DOWNDRAFT TABLE
- WET BOOTH
- HEPA AFTERFILTER
- EXHAUST SILENCER
- MERV 16 A-FRAME AFTER FILTER

## HOW IT WORKS:

Dust and particulate enter the HYDROMAX® wet collector through ducting in the rear of the filter cabinet. The contaminated air is mixed into a turbulent water bath, and runs through a series of internal baffles. The engineered baffles, and water streams filter and drop out the combustible dust where it is contained in the bottom of the collector for safe removal, at necessary intervals with the provided sludge rake. Water levels are automatically controlled through our flow valve system that can be interlocked with the dust producing equipment to meet OSHA and NFPA requirements for combustible dusts.

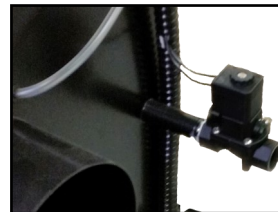

Fill Valve

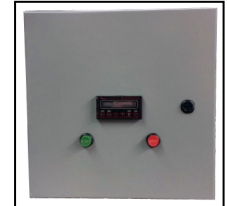

Control Panel

Standard auto-fill valve and interlocking control panel



WC5000 / WCDDT7230

L2662-WC5000 / WCDDT7230-04/22



# WC5000/WCDDT7

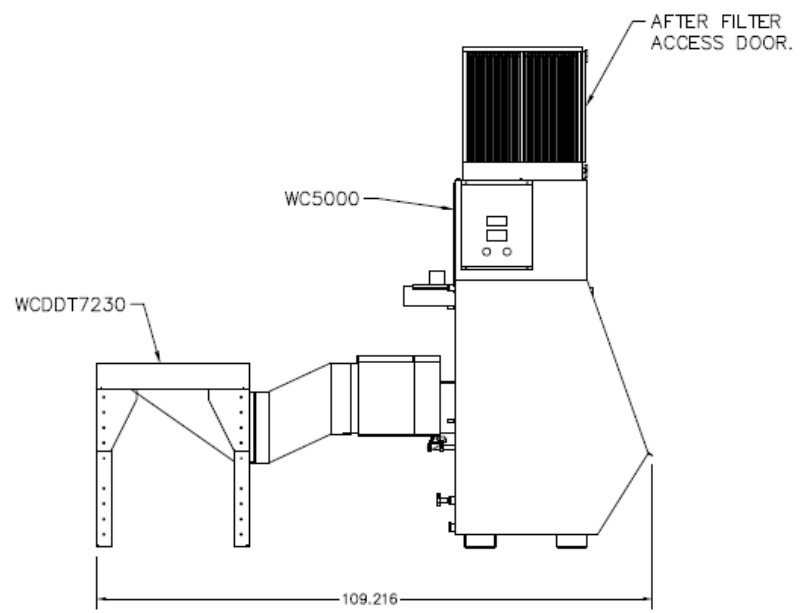
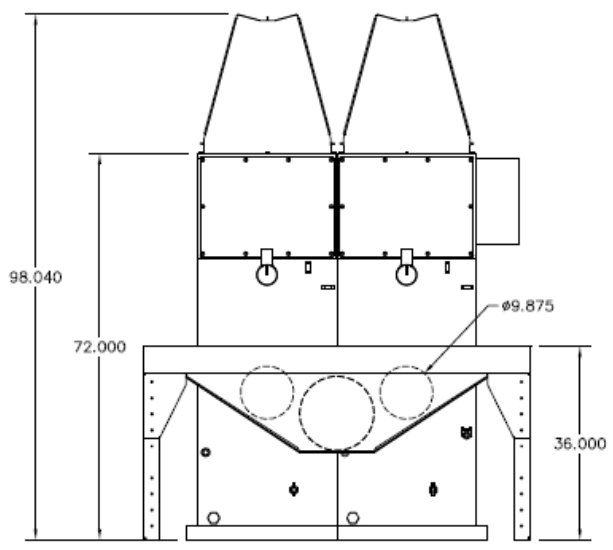
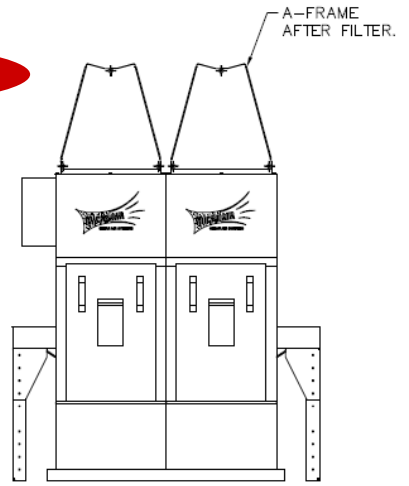
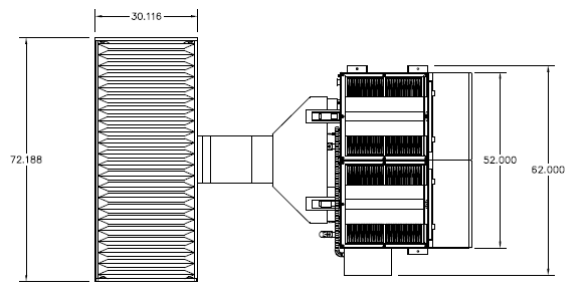

## WC5000 / WCDDT7230 & MERV 16 A-Frame Afterfilter

### WC5000 SPECIFICATIONS:

<p><b>OVERALL DIMENSIONS:</b>          72.5" H X 60" W X 49" D          72.5" H X 72" W X 109" D WITH WCDDT7230 DOWNDRAFT TABLE          98.5" H X 60" X 49" D WITH A-FRAME AFTERFILTER</p> <p><b>WEIGHT:</b>          *1,400 LBS ACTUAL WEIGHT          *1,550 LBS SHIPPING WEIGHT          *WEIGHT VARIES DEPENDING UPON OPTIONS SELECTED</p> <p><b>CABINET:</b>          HEAVY DUTY 16 GA. WELDED 304 STAINLESS STEEL W/EXTERIOR SURFACES GROUND SMOOTH</p> <p><b>FINISH:</b>          MARINE GRADE BLACK POWDER COAT FINISH</p> <p><b>FILTER ACCESS:</b>          LIFT OFF FRONT PANEL FOR EASY CLEANOUT OF COLLECTED SLUDGE</p> <p><b>MOTOR:</b>          5 HP, TEFC, WASHDOWN MOTOR, 208 / 230 OR 460V, THREE PHASE</p> <p><b>BLOWER:</b>          STAINLESS STEEL, BACKWARD INCLINED, DIRECT DRIVE BLOWER</p> <p><b>AIR VOLUME:</b>          CONSULT FACTORY</p> <p><b>CONTROLS:</b>          FACTORY WIRED AND INSTALLED NEMA 4 CONTROL PANEL, COMPLETE WITH MOTOR STARTER, OVERLOAD PROTECTION, DIGIHELIC FLOW CONTROL AND PUSHBUTTON START / STOP</p>	<p><b>INLET / EXHAUST:</b>          DUAL 10" DIAMETER INLETS ON BACK OF CABINET,          VERTICAL DISCHARGE IN THE TOP OF THE FILTER CABINET</p> <p><b>SUMP VENT:</b>          DUAL 4" DIAMETER ELECTRONICALLY CONTROLLED AND EQUIPPED STANDARD</p> <p><b>MAX CURRENT</b>          208—230V / 460V—26.8 / 13.4 AMP</p> <p><b>NOISE LEVELS:</b>          84 dBA @ 5' - NO SILENCER          78 dBA @ 5' WITH SILENCER</p> <p><b>WCDDT7230:</b>          72" X 30" DOWNDRAFT TABLE WITH SLOPED INTER-CONNECTING HOPPER—SUPPLIES 240 FPM DOWNDRAFT VELOCITY</p> <p><b>WATER USAGE:</b>          3.12 GAL / HR</p>
---	---

SPECIFICATIONS SUBJECT TO CHANGE WITHOUT NOTICE